

CVMW2035-IR

2MP High Performance IP Vandal Dome camera H.264, MJPEG

VANDERBILT



H.264 & MJPEG dual encoding functionality allows the use of the Vanderbilt 2MP High Performance IP Vandal Dome camera in almost any networking surveillance application. The camera offers superior image performance under extreme lighting conditions with its on-board IR light, BLC and enhanced true WDR functionality. Additionally 4 analytic disciplines are included for added functionality and detection purposes. A mechanically removable IR-cut filter allows the day/night camera to provide excellent colour pictures and quality in day mode also allowing IR- sensitive crisp, clear monochrome images at night. Combined with the anti-sabotage dome casing this product combines excellent 24/7 surveillance and performance.

Key Features include:

- H.264 & MJPEG dual encoding
- Frame Rate :
 - 1080P(1920x1080) @60/50 fps for single streaming
 - 1080P(1920x1080) @30/25 fps for multiple streaming
- Bidirectional audio input/output
- ONVIF streaming profile S support
- Wide dynamic range functionality (105 dB)
- Exceptional low-light sensitivity: 0.01 lux @ B/W
- Basic motion detection
- Enhanced VCA indoor analytic (uncrowded areas)
- Support of up to 3 different sizes of video cropping area
- Micro SDHC card for local storage (max 64GB)
- 4 user-definable privacy zones
- Alarm and Audio input/output
- Optional heater function selectable for low temperature usage -40°C
- Smart housing design supports ceiling and flush mount applications.
- Anti scratch coated bubble / hemisphere.
- Motorized IR coated vari-vocal lense 3,3 -10 with one push autofocus
- Vandal indoor / outdoor design (IK10 / IP66)

CVMW2035-IR

2MP High Performance IP Vandal Dome camera H.264, MJPEG

VANDERBILT

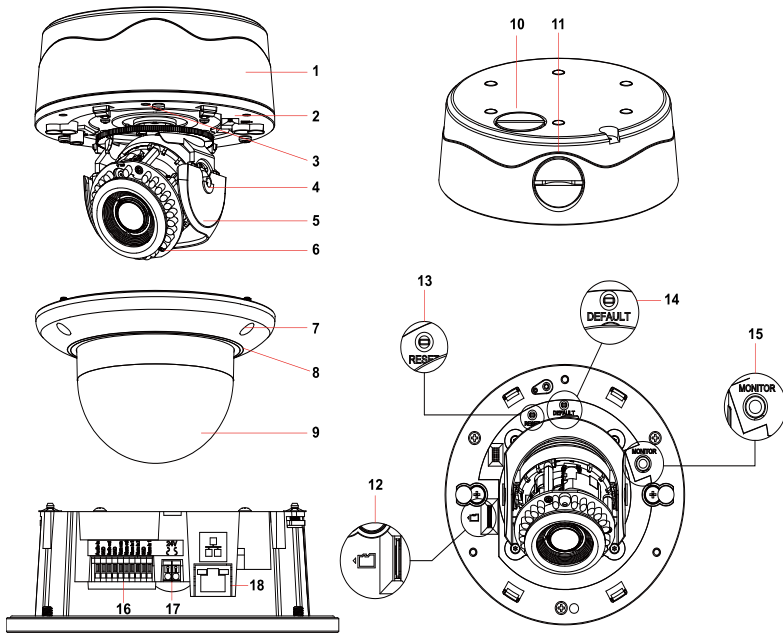

Legend/Dimensions

- 1 Camera bottom case
- 2 Camera lens base
- 3 The screws of camera lens base (x3)
- 4 Tilt adjustment bracket
- 5 Inner liner
- 6 IR board
- 7 The screws of camera housing (x3)
- 8 Camera housing
- 9 Dome cover
- 10 Bottom conduit hole
- 11 Side conduit hole
- 12 Micro SD card slot
- 13 Reset button
- 14 Default button
- 15 Monitor out port
- 16 I/O connectors
- 17 AC 24V terminal
- 18 RJ-45 Ethernet connector

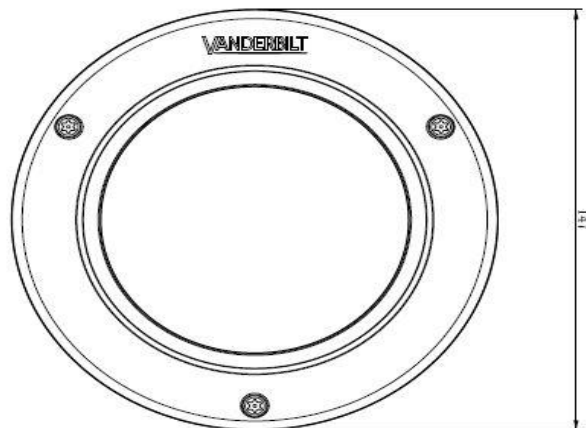
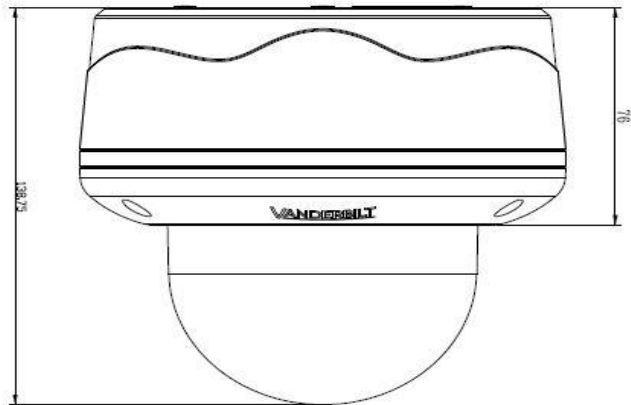

VANDERBILT

CVMW2035-IR

2MP High Performance IP Vandal Dome camera H.264, MJPEG

VANDERBILT

■ Technical Data

Model	CVMW2035-IR
-------	-------------

Signal system	NTSC/PAL
---------------	----------

Optical System

Lens mount	Φ14 Straight mount
------------	--------------------

Auto iris control	DC Iris
-------------------	---------

Focal Length	motorized 3.3~10mm
--------------	--------------------

Aperture	F1.3
----------	------

Angle of View	16:9 Wide 110° (Horizontal) 60° (Vertical) Tele 35° (Horizontal) 20° (Vertical)
---------------	--

Day / Night	Mechanical ICR
-------------	----------------

Image System

Image Sensor	1/2.8" IMX140LAJ CMOS
--------------	-----------------------

Electrical

Digital noise reduction	3D
-------------------------	----

Gamma correction	0.45/1
------------------	--------

Minimum Illumination	Colour: <0.02 lux (F1.3) 50 IRE, 1/25, AGC OFF, Max. Gain BW: <0.01 lux (F1.3) 50 IRE, 1/25, AGC OFF, Max. Gain
----------------------	--

Gain control	Off/ On, selectable
--------------	---------------------

White balance	ATW(2800K~8500K) /Manual
---------------	--------------------------

S/N Ratio	50dB (AGC off)
-----------	----------------

IR LED	20 pcs
--------	--------

IR wavelength	850nm
---------------	-------

VANDERBILT

CVMW2035-IR

2MP High Performance IP Vandal Dome camera H.264, MJPEG

VANDERBILT

Network Specifications	
Video compress	H.264/ MJPEG
Video streaming	Triple streaming
Frame Rate	1080P(1920x1080) @60/50 fps for single streaming; 1080P(1920x1080) @30/25 fps for multiple streaming;
Resolution	1080P(1920x1080), 720P(1280x720), D1(720x576/720x480) VGA(640x480), CIF(352x288/352x240), QVGA(320x240)
Network protocols	TCP/IP ,UDP, HTTP, HTTPs, SMTP,SNMPv3, DNS, DHCP, NTP, ARP, ICMP, FTPc, FTPs, DDNS, RTP, (RTCP,RTSP) IGMPv3, UPnP, CIFS, NFS, IEEE802.1x
Slow shutter	Yes
WDR	True WDR (105 dB)
Back light compensation	Off/On (6 Area selectable)
Audio format	G.711-Alaw / G.711-Ulaw
Privacy zone	Yes
Tamper Detection	Yes
Basic Motion Detection	Yes
VCA functions	Object Counting, Loitering, Take Away, Abandoned Objects (indoor usage, uncrowded area)
OSD function	Yes (Text, Date, Time)
Security Access	Three user access levels with password protection
Users	5 users accounts
ONVIF	ONVIF streaming profile S
Web browsing requirements	IE10 / IE11, (SAFARI, Firefox, and Google chrome, only streaming)

VANDERBILT

CVMW2035-IR

2MP High Performance IP Vandal Dome camera H.264, MJPEG

VANDERBILT

Mechanical / Environmental	
Dimensions	H=138.75mm Ø=147mm
Weight	1300g
Colour	Cool Gray 2C
IP rating	IP66
IK rating	IK10
Connectors	Video Out Reset / Default Network: RJ45 connector Power Input: Spring-Terminal block Audio In/out: removable terminal block Alarm In/out: removable terminal block
Operating temperature	-40°C to +50°C
Operating humidity	90%, non-condensing
Storage temperature	-40°C to +60°C
Storage humidity	90%, non-condensing
Power Supply	
Power requirements	AC24V/PoE+
Power consumption	26W(MAX)(with heater)/15W(MAX)(without heater)

Details for ordering:

Type	Part no.	Designation	Weight
CCMW2035-IR	V54561-C127-A100	2MP IP Vandal proof, Varifo	1,3 kg

VANDERBILT

CVMW2035-IR

2MP High Performance IP Vandal Dome camera H.264, MJPEG

VANDERBILT

Issued by
Vanderbilt
Clonshaugh Business and
Technology Park
Clonshaugh
Dublin 17
Ireland
www.vanderbiltindustries.com

© Vanderbilt 2015
Data and design subject to change without notice.
Supply subject to availability.
Document version/no.: 1.0/C-300563
Edition: 28.07.2015

VANDERBILT